

**PLANTING PLAN**  
Scale: 1" = 20'

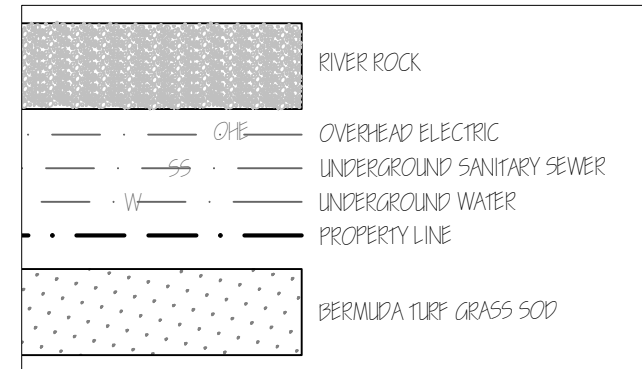

**DRAWING KEY**

Common Name	Botanical Name	Texas Native	Size	Qty	Remarks	Shade area	Extended shade area
Butterfly Weed	<i>Asclepias tuberosa</i>	Perennial	Yes	1 gal	4 full pots		
Cedar Elm	<i>Ulmus crassifolia</i>	Tree	Yes	65 gal	3 3' cal	875	2,625
Desert Willow	<i>Chiosotis linearis</i>	Tree	Yes	45 gal	5 10' height	275	1,375
Lindheimer Muhly / Big Muhly	<i>Muhlenbergia lindheimeri</i>	Grass	Yes	5 gal	5 full pots		
Little Bluestem	<i>Schizachyrium scoparium</i>	Grass	Yes	1 gal	23 full pots		
Mexican Buckeye	<i>Unguisia speciosa</i>	Small tree	Yes	25 gal	3 8' height	275	825
Mexican Oregano	<i>Potamothele longiflora</i>	Perennial	Yes	1 gal	15		
Mexican Sycamore	<i>Platanus mexicana</i>	Tree	No	65 gal	3 3' cal	1,200	3,600
Red Yucca	<i>Hesperaloe parviflora</i>	Shrub-like	Yes	5 gal	4 full pots		
Rock Rose / Pavonia	<i>Pavonia lasiopetalata</i>	Perennial	Yes	1 gal	14 full pots		
Rosemary, Upright	<i>Rosmarinus officinalis</i>	Perennial	No	3 gal	12 full pots		
Shumard Red Oak	<i>Quercus shumardii</i>	Tree	Yes	65 gal	4 3' cal	1,200	4,800
Sideoats Grama	<i>Bouteloua curtipendula var caespitosa</i>	Grass	Yes	1 lb	seed		
Skullcap, Wrights	<i>Scutellaria wrightii</i>	Perennial	Yes	1 gal	11 full pots		
Texas Lantana	<i>Lantana urticoides (horrida)</i>	Perennial	Yes	1 gal	3 full pots		
River Rock	Arizona, 1.5" - 3" size, 4" depth				240 sq. ft.		
Bermuda grass sod	Tiff 419				19,263 sq. ft.		
Ceramic Pot + saucer	Golden Chick custom mold 32" x 20" + 15" saucer				4 each		
Metal Edging	1/4 gal, green metal 4" size edging with stakes				205 lin. ft.		
Potting soil	See detail				12 cu. ft.		
Total Site Shade						13,225	

**PLANT LIST**

**Jurisdiction of Project**

REGULATORY AUTHORITIES:  
CITY OF SAN ANTONIO PLANNING & ZONING  
1400 S FLORES STREET  
SAN ANTONIO, TEXAS 78208  
210.207.0145  
TEXAS DEPARTMENT OF LICENSING AND REGULATION  
ELIMINATION OF ARCHITECTURAL BARRIERS  
E.O. THOMPSON STATE OFFICE BUILDING  
920 COLORADO  
AUSTIN, TEXAS 78701  
(512) 463-3211  
(512) 475-2886 (FAX)

**Landscaping Requirements**

CITY OF SAN ANTONIO UNIFIED DEVELOPMENT CODE  
ARTICLE V - DEVELOPMENT STANDARDS  
DIVISION 3 - LANDSCAPE AND TREE PRESERVATION

**A. BUFFER YARDS**  
EXEMPT - SAME ZONING CLASSIFICATIONS

**B. PARKING LOT SHADING**  
CANOPY TREES SHADE A MIN OF 25% OF PARKING AREA  
(60% PROVIDED FOR ELECTIVE POINTS)  
4,964 SF PARKING AREA x 50%  
REQUIRED: 2,482 SF TREE SHADE  
PROVIDED: 2,580 SF TREE SHADE  
1 SHUMARD RED OAK PLANTED IN ISLAND ----- 75% \* 1200= 900  
2 CEDAR ELM PLANTED IN ISLAND ----- 75% \* 1750= 875  
1 DESERT WILLOW PLANTED IN ISLAND ----- 75% \* 275= 206  
1 SHUMARD RED OAK WITHIN 12' OF PARKING----- 50% \* 1200= 600

**C. 70 ELECTIVE REQUIREMENTS REQUIRED**  
SCREENING OF SURFACE PARKING 25 POINTS  
PARKING LOT SHADING (50% SHADING) 35 POINTS  
UNDERSTORY RECLAMATION 15 POINTS

**D. SITE TREE COVERAGE (SITE- 51,836 SF)**  
REQUIRED: (25%) 12,959 SF  
PROVIDED: (35%) 13,225 SF

**Irrigation Requirements**

UNDERGROUND AUTOMATIC SPRINKLING SYSTEM PROVIDED. SYSTEM DESIGNED AND INSTALLED ACCORDING TO TCEQ LAWS AND REGULATIONS PROVIDING FOR 100% COVERAGE ON ALL LANDSCAPE AND TURF. THE SYSTEM SHALL INCLUDE A FREEZE-RAIN SENSOR.

**Site Location**

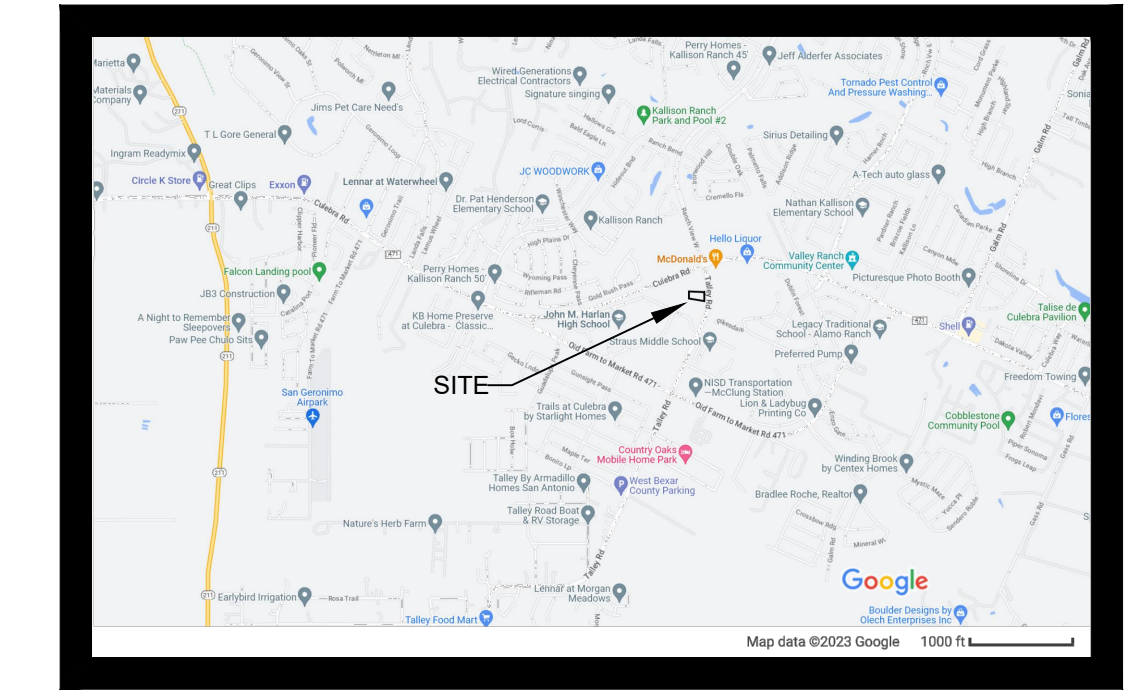

**Owner & Professionals Information**

**OWNER**  
GOLDEN CHICK OPERATION CORPORATION  
1131 ROCKINGHAM DR. SUITE 250, RICHARDSON, TX 75080  
ATTN: BRIAN GILBERT, 972-831-0911

**ARCHITECT**  
MLA - MICHAEL LEGG ARCHITECT  
26116 HIGH TIMBER PASS  
SAN ANTONIO, TEXAS 78260  
ATTN: MICHAEL LEGG, 210-416-4935

**LANDSCAPE ARCHITECT**  
FELDMAN DESIGN STUDIOS  
P.O. BOX 832346, RICHARDSON, TEXAS 75083  
ATTN: CAROL FELDMAN, 972-523-4944  
CAROL@FELDMANDESIGN.COM

NO.	ITEM DESCRIPTION
1.	SUBMITTAL DOCUMENTS
2.	
3.	
4.	
5.	
6.	
7.	



These drawings have been prepared by or under the supervision of Carol Feldman, Registered Landscape Architect #2080, Licensed Irrigator LI #20245

**GOLDEN CHICK RESTAURANT**  
TALLEY RD AT CULEBRA  
SAN ANTONIO, TEXAS



SHEET NO.

**L1.01**

NO.	ITEM DESCRIPTION
1.	SUBMITTAL DOCUMENTS
2.	
3.	
4.	
5.	
6.	
7.	

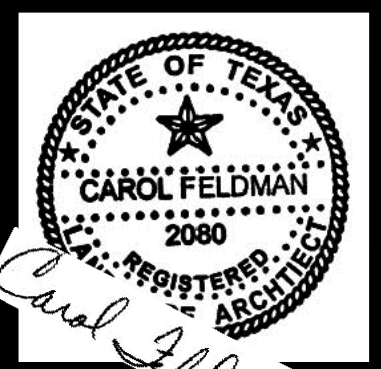

These drawings have been prepared by or under the supervision of Carol Feldman, Registered Landscape Architect #2080, License #20245

**GOLDEN CHICK RESTAURANT**  
**TALLEY RD AT CULEBRA**  
**SAN ANTONIO, TEXAS**



SHEET NO.

**L1.02**

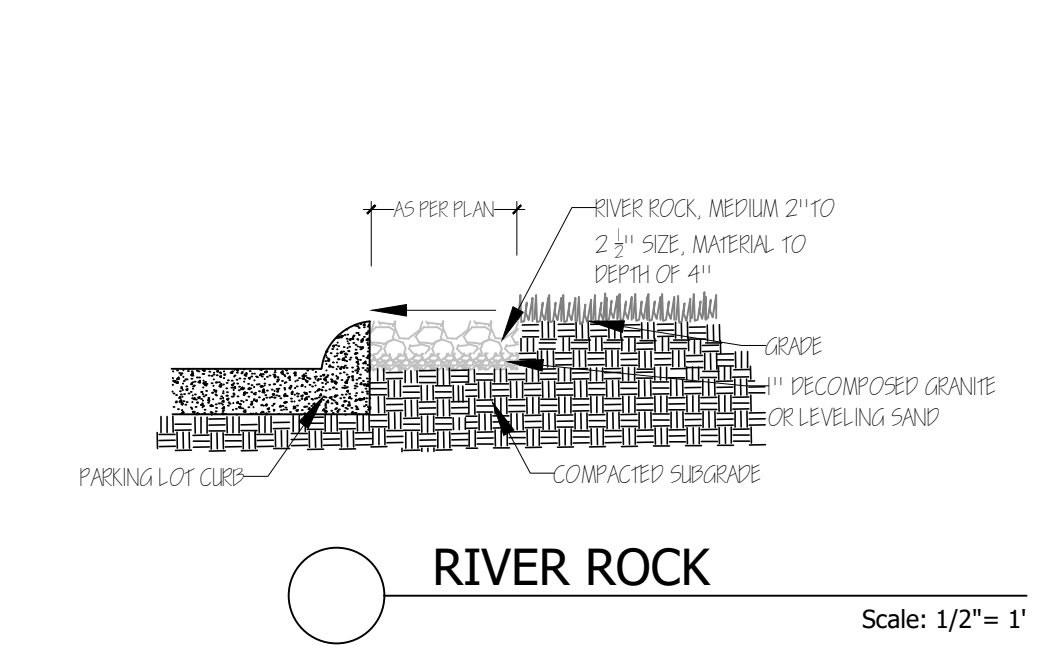

**RIVER ROCK**  
 Scale: 1/2" = 1'

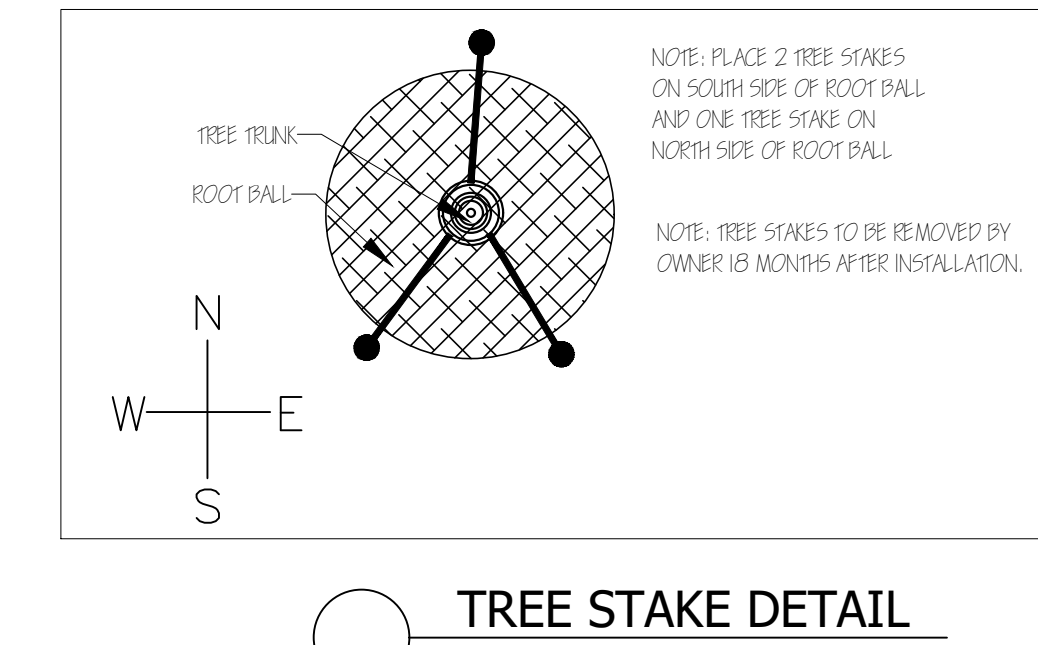

**TREE STAKE DETAIL**  
 Scale: 1/2" = 1'

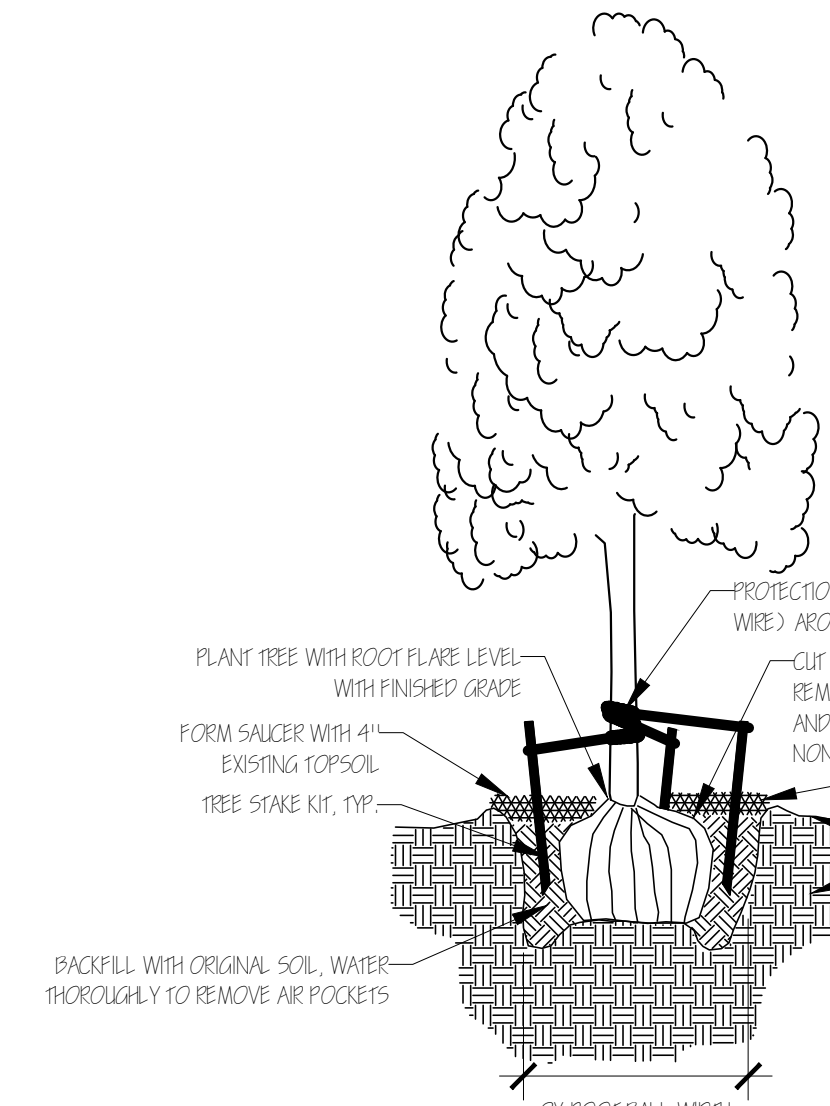

**TREE PLANTING**  
 Scale: Not to scale

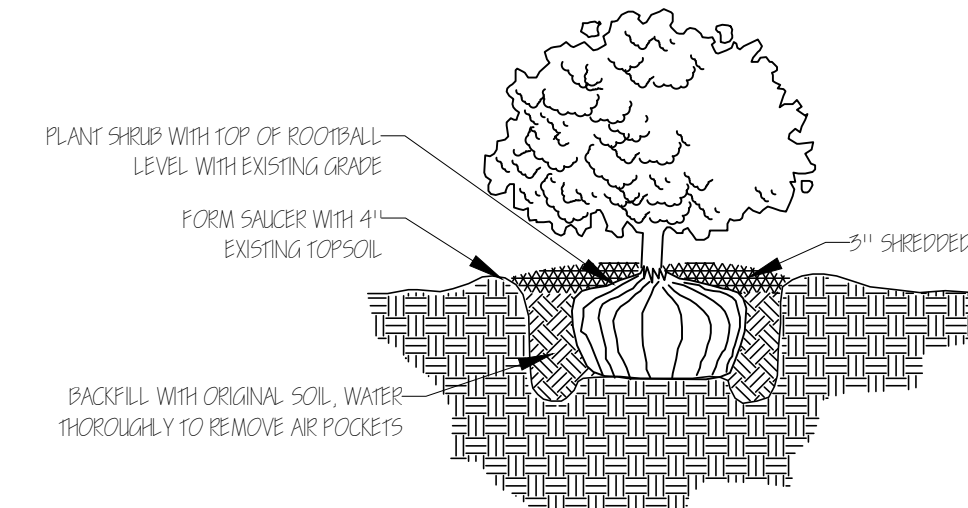

**SHRUB & ORNAMENTAL GRASS PLANTING DETAIL**  
 Scale: Not to scale

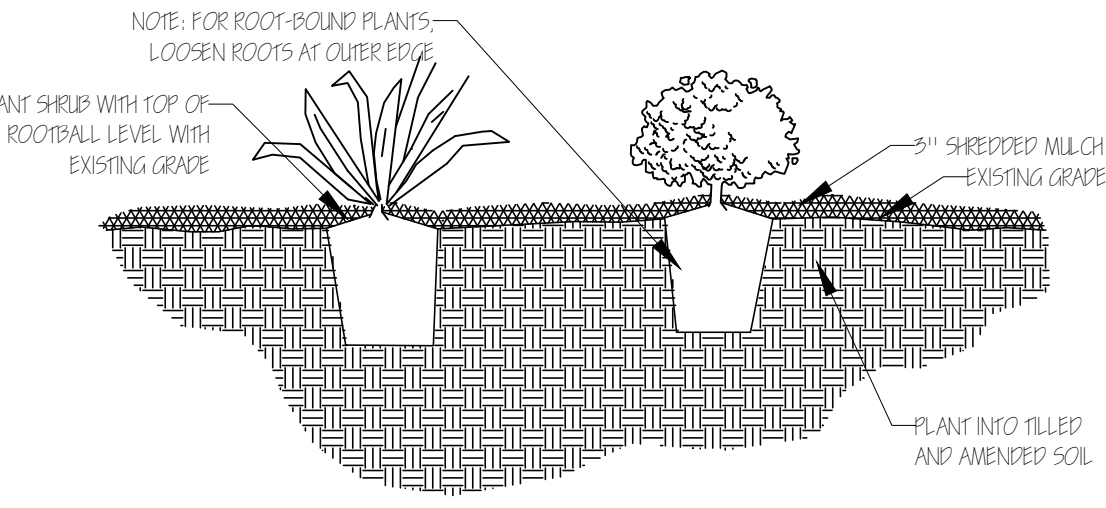

**PERENNIAL PLANTING DETAIL**  
 Scale: Not to scale

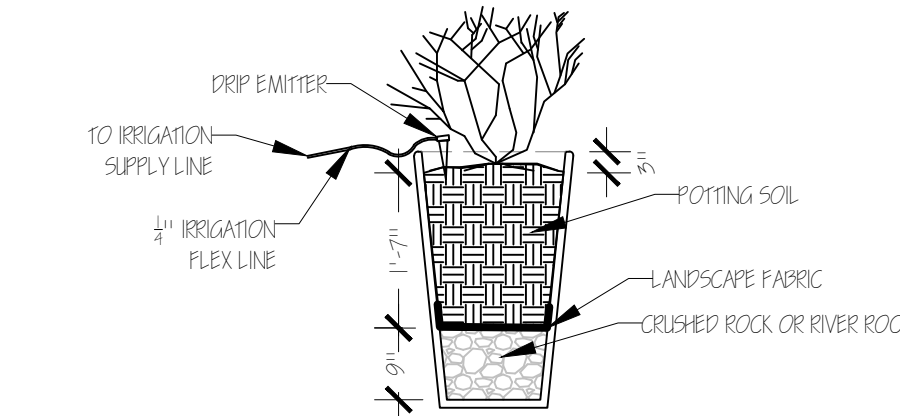

**POT PLANTING DETAIL**  
 Scale: 1/2" = 1'



**CERAMIC POTS & SAUCERS**  
 Not to Scale  
 GOLDEN CHICK CUSTOM MOLD RIPPLE POT  
 32" TALL X 20" DIAMETER - TEAL COLOR  
 15" DIAMETER SAUCER (NOT SHOWN)  
 AVAILABLE BY CONTACTING CORPORATE  
 GOLDEN CHICK, RICHARDSON

**SECTION 02910 - SOIL PREPARATION**

**PART 1 - GENERAL**

A. DESCRIPTION

1. PROVIDE COMPLETE GRADING AND SOIL PREPARATION, INCLUDING AMENDMENTS, AS SPECIFIED HEREIN.

B. EXAMINATION

1. EXAMINE SITE TO VERIFY REQUIRED ROUGH GRADING HAS BEEN COMPLETED CORRECTLY PRIOR TO BED PREPARATION WORK.
2. EXAMINE SITE TO VERIFY THAT ALL INVASIVE PLANTS AND THEIR ROOTS HAVE BEEN REMOVED PRIOR TO BED REPARATION WORK.

C. APPROVALS

1. ALL 'APPROVED EQUAL' MATERIALS MUST BE APPROVED BY LANDSCAPE ARCHITECT.

**PART 2 - PRODUCTS**

A. MATERIALS

1. COMPOST:
  - 1.1. COTTON BUR COMPOST
  - 1.2. SHALL BE SUPPLIED BY: GREENSENSE COMPOST, GARLAND, TX. OR, CLEAR FORK MATERIALS, ALEDO, TX, OR APPROVED EQUAL.
2. FERTILIZERS AND SUPPLEMENTS:
  - 2.1. A 6-2-4 GRANULAR FERTILIZER WITH A WATER SOLUBLE SLOW RELEASE ORGANIC BASE SUCH AS GREENSENSE, OR SUSTANE, OR APPROVED EQUAL.
3. MULCH
  - 3.1. SHALL BE SHREDDED HARDWOOD MULCH, SHREDDED CEDAR MULCH, SHREDDED NATIVE MULCH, OR APPROVED EQUAL.

**PART 3 - EXECUTION**

A. BED PREPARATION AND PREPARATION FOR SOD INSTALLATION

1. GENERAL
  - 1.1. INSPECT ALL EXISTING CONDITIONS AND OTHER ITEMS OF WORK PREVIOUSLY COMPLETED. DO NOT PROCEED UNTIL DEFECTS ARE CORRECTED.
  - 1.2. INSPECT THAT ALL INVASIVE PLANTS AND THEIR ROOTS HAVE BEEN REMOVED COMPLETELY.
  - 1.3. ALL AREAS TO BE PREPARED WITH ORGANIC TECHNIQUES ONLY.
2. SHRUB BEDS:
  - 2.1. BREAK UP AND TILL EXISTING SOIL TO A DEPTH OF 6 INCHES,
  - 2.2. ADD A 3 INCH LAYER OF COMPOST TO THE BEDS,
  - 2.3. TILL EXISTING SOIL AND COMPOST TOGETHER TO A TOTAL OVERALL DEPTH OF 8 INCHES.
  - 2.4. RAKE OUT ROCKS AND CLODS AND FINE GRADE THE BEDS TO DRAIN IN APPROPRIATE DIRECTIONS.
  - 2.5. TOP-DRESS BED WITH A 3 INCH LAYER OF MULCH AFTER PLANTING.
3. SOD AND SEED AREAS
  - 3.1. LIGHTLY CULTIVATE COMPACTED SOIL AND RAKE THE SOIL SMOOTH.
  - 3.2. ADD 1/2 INCH COMPOST TO ALL AREAS.
  - 3.3. FINE GRADE TO DRAIN IN APPROPRIATE DIRECTIONS.

END OF SECTION 02910

**NOTES**

**GENERAL LANDSCAPE**

1. LANDSCAPE CONTRACTOR IS RESPONSIBLE FOR LOCATING ALL UNDERGROUND UTILITIES AND STRUCTURES WHETHER OR NOT SHOWN ON THE PLANS, AND SHALL BE RESPONSIBLE FOR DAMAGE TO SAID UTILITIES OR STRUCTURES CAUSED BY HIS/HER CREW AND SUBCONTRACTORS.
2. NO PLANTING TO TAKE PLACE UNTIL OWNER HAS INSPECTED AND APPROVED THE BED PREPARATION.
3. NO PLANTING TO TAKE PLACE UNTIL OWNER HAS INSPECTED AND APPROVED ALL PLANT MATERIAL AND ALL PLANT PLACEMENT. FIELD ADJUSTMENTS OF PLANT LOCATIONS TO BE COORDINATED WITH OWNER.
4. ALL CANOPY AND ORNAMENTAL TREES TO BE STAKED (SEE DETAIL.)
5. ALL LAWN AND LANDSCAPE BED AREAS ARE TO BE SEPARATED BY 14 GAUGE EDGING UNLESS OTHERWISE NOTED ON THE PLANS.

**SECTION 02915 - LANDSCAPE PLANTING**

**PART 1 - GENERAL**

A. SPECIAL CONDITIONS

1. COMPLY WITH APPLICABLE FEDERAL, STATE, COUNTY AND LOCAL REGULATIONS GOVERNING LANDSCAPE MATERIALS AND WORK.
2. EMPLOY ONLY EXPERIENCE PERSONNEL FAMILIAR WITH REQUIRED WORK. PROVIDE ADEQUATE SUPERVISION BY A QUALIFIED FOREMAN WITH A MINIMUM OF TEN(10) YEARS EXPERIENCE WITH PROJECTS OF SIMILAR COMPLEXITY.
3. DO NOT MAKE SUBSTITUTIONS OF TREE, SHRUB AND GRASS MATERIALS. IF REQUIRED MATERIAL IS NOT OBTAINABLE, SUBMIT PROOF OF NON-AVAILABILITY TO OWNER'S REPRESENTATIVE.
4. PROVIDE QUANTITY, SIZE, GENUS, SPECIES AND VARIETY OF TREES AND SHRUBS INDICATED AND SCHEDULED FOR LANDSCAPE WORK WHICH COMPLY WITH APPLICABLE REQUIREMENTS OF ANSI Z60.1 \*AMERICAN STANDARD FOR NURSERY STOCK\*, AND ANY APPLICABLE STATE AND FEDERAL LAWS CONCERNING DISEASE AND INSECT INFESTATION.

B. REFERENCE STANDARDS

1. AMERICAN STANDARD FOR NURSERY STOCK, ANSI Z60.1, 2014 BY AMERICAN NATIONAL STANDARDS INSTITUTE, INC.
2. SHINNERS & MAHLER'S, ILLUSTRATED FLORA OF NORTH CENTRAL TEXAS, BOTANICAL RESEARCH INSTITUTE OF TEXAS (BRIT), FORT WORTH, TEXAS, 1999.
3. HORTUS THIRD, CORNELL UNIVERSITY, 1967.

C. PREPARATION

4. COORDINATION WITH BUILDING AND ENGINEERING PROJECT ACTIVITIES.
5. COORDINATE THE WORK OF THIS SECTION WITH THAT OF REGULAR AND EMERGENCY WATER UTILITY ACTIVITIES ON THE SITE.
6. COORDINATION WITH IRRIGATION SYSTEM:
  - 6.1. THE UNDERGROUND IRRIGATION SYSTEM MUST BE INSTALLED PRIOR TO COMMENCEMENT OF THE PLANTING OPERATIONS.
  - 6.2. THE IRRIGATION SYSTEM SHALL BE OPERATIONAL AT THE TIME THAT PLANTING OPERATIONS COMMENCE.
  - 6.3. COORDINATE WORK WITH THE IRRIGATION CONTRACTOR TO PREVENT DAMAGE TO THE IRRIGATION SYSTEM.

D. ALL PLANT MATERIALS FOR THIS PROJECT SHALL BE NURSERY-GROWN, INCLUDING TREES.

1. CONTAINER GROWN PLANTS SHALL HAVE BEEN 'STEPPED-UP' AS NECESSARY TO PREVENT ROOT GIRDLING.
2. CONTAINER GROWN PLANTS SHALL HAVE BEEN IN THE CONTAINER FOR A MINIMUM OF SIX (6) MONTHS PRIOR TO DELIVERY TO THE SITE TO ENSURE ADEQUATE ROOT DEVELOPMENT.
3. THE 'ROOT FLARE' OF ALL TREES AND SHRUBS SHALL NOT BE COVERED WITH SOIL.

E. THE FOLLOWING TREE CARE PROCEDURES SHALL BE ADHERED TO:

1. DO NOT MAKE FLUSH CUTS OR LEAVE STUBS WHEN PRUNING. LEAVE THE BRANCH COLLAR INTACT.
2. DO NOT USE ANY TYPE OF PRUNING PAINT ON WOUNDS.
3. DO NOT USE ANY TYPE OF TREE WRAP, EXCEPT, TRUNKS MAY BE WRAPPED WITH BURLAP DURING PLANTING OPERATIONS ONLY.
4. STAKE AND GUY ANY TREES AS PER DETAIL. THE CONTRACTOR WILL BE RESPONSIBLE FOR THE REMOVAL OF STAKES AND GUYS AFTER TREES HAVE BEEN IN THE GROUND 6 MONTHS, AND BEFORE THE ONE YEAR ANNIVERSARY OF PLANTING.
5. DO NOT HANDLE ANY TREE BY ITS TRUNK. ANY TREE HANDLED IN SUCH A MANNER SHOULD BE REJECTED.

F. WARRANTY

1. UNCONDITIONALLY WARRANT ALL PLANTS FOR A PERIOD OF ONE (1) YEAR AFTER THE DATE OF INSTALLATION INITIAL ACCEPTANCE. REPLACE MATERIALS NOT IN VIGOROUS, THRIVING CONDITION AS SOON AS WEATHER PERMITS AFTER NOTIFICATION BY OWNERS THAT THE PLANTS HAVE DIED OR ARE OTHERWISE NOT ACCEPTABLE. GUARANTEE REPLACEMENT PLANTS FOR ONE YEAR, STARTING FROM THE DATE REPLACEMENT IS MADE.
2. WARRANTY EXCLUDES REPLACEMENT OF PLANTS BECAUSE OF INJURY BY STORM, NATURAL DROUGHT, DROWNING, HAIL, OR FREEZING, IF REASONABLE CARE WAS TAKEN TO ADEQUATELY PROTECT THE MATERIAL, AND IN THE OPINION OF THE OWNER'S REPRESENTATIVE THAT THE PROBLEM OCCURRED AFTER THE DATE OF INITIAL ACCEPTANCE.

**PART 3 - EXECUTION**

A. PREPARATION FOR PLANT MATERIAL INSTALLATION

1. EXAMINE THE SUB-GRADE UPON WHICH THE WORK IS TO BE PERFORMED, VERIFY GRADE ELEVATIONS AND VERIFY THAT BEDS HAVE BEEN LEFT LOW BY OTHER TRADES. OBSERVE THE CONDITIONS UNDER WHICH THE WORK IS TO BE PERFORMED AND CONFIRM THAT UNSATISFACTORY CONDITIONS HAVE BEEN CORRECTED PRIOR TO PROCEEDING.

B. TIME OF PLANTING

1. CARE IS TO BE TAKEN SO THAT NO PLANTS SIT IN POTS IN THE SUMMER HEAT FOR MORE THAN 1 HOUR. IF PLANTING DURING HOT SEASONS (NOT PREFERRED) PLANTING IS TO BE DONE IN SMALL SECTIONS WITH STOCKPILED PLANTS TO BE PROTECTED FROM THE SUMMER HEAT (SHADE AREAS).

C. TREE PLANTING

1. STAKE LOCATIONS FOR TREES PRIOR TO DIGGING HOLES.
2. DIG PITS WITH ROUGH SIDES AND WHICH HAVE TAPERED WALLS, A MINIMUM OF TWICE THE WIDTH OF THE TREE BALL. A PEDESTAL SHOULD BE LEFT IN THE CENTER OF THE HOLE AND THE TREE BALL SET UPON THAT PEDESTAL.
3. SET PLANTS IN THE CENTER OF THE HOLE AND ON THE PEDESTAL, PLUM AND VERTICAL, AND AT SUCH A DEPTH THAT THE CROWN OF THE TREE BALL WILL BE LEVEL WITH THE SURROUNDING GRADE.
4. ALL PLANTS SHALL BE SET TO MEET THE SAME RELATIONSHIP TO THE FINISHED GRADE OF THE SURROUNDING SOIL THAT THEY BORE TO PREVIOUS EXISTING GRADE OF SOIL.
5. BACKFILL WITH EXISTING TOPSOIL AND WATER IMMEDIATELY.
6. FORM A SHALLOW BASIN SLIGHTLY LARGER THAN THE PIT TO FACILITATE WATERING. REMOVE PRIOR TO MULCHING.
7. COVER ALL TREE BALLS WITH A MINIMUM OF 3" OF SPECIFIED MULCH. EXTEND MULCH OUT TO THE EDGE OF THE TREE PIT, BUT KEEP AWAY FROM TRUNKS.
8. ALL EXCAVATED MATERIAL UNACCEPTABLE FOR REUSE SHALL BE DISPOSED OF OFF SITE, OR AS DIRECTED BY THE OWNER.

D. SHRUBS, TALL GRASSES AND PERENNIAL PLANTING

1. REMOVE CONTAINER AND SET PLANT MATERIAL AT SUCH A LEVEL THAT AFTER SETTLEMENT, THE CROWN OF THE BALL WILL BE AT FINISHED GRADE.
2. GENTLY CUT OUTER ROOTS OF ANY ROOTBALLS THAT HAVE 'POT-BOUND' PRIOR TO INSTALLATION.
3. COVER PLANTING BEDS WITH A MINIMUM 3" LAYER OF SPECIFIED MULCH.

E. SOD PLANTING

1. LAY SOD IN AN ORDERLY MANNER TO COVER ALL BARE SOIL AREAS.
2. WATER ALL AREAS OF THE SOD UNTIL THOROUGHLY WET.
3. ROLL SOD WITH A SOD ROLLER AFTER 24 HOURS AFTER LAYING AND WATERING SOD TO OBTAIN A UNIFORM, SMOOTH FINISH.
4. FILL JOINTS WITH COMPOST IF NECESSARY TO FORM A UNIFORM GRASS LAYER.
5. KEEP SOD ADEQUATELY WATERED UNTIL SOD MAKES A FIRM CONNECTION TO THE SOIL.

F. SEED PLANTING

1. AREAS SHALL BE RAKED TO A DEPTH OF 1/2", SMOOTH AND FREE OF STONES AND DEBRIS.
2. APPLY SEED EVENLY AT THE RATE RECOMMENDED.
3. RAKE AND WATER TO ESTABLISH A FIRM CONNECTION OF THE SEED TO THE SOIL.
4. KEEP SEED AREA MOIST (NOT WET) UNTIL SEED GERMINATES AND GRASS IS APPROX. 1/2" IN HEIGHT.
5. KEEP AREA ADEQUATELY WATERED UNTIL A STAND OF THE GRASS IS ESTABLISHED.
6. RE-SEED TO ESTABLISH A THICK STAND OF GRASS IF NECESSARY.

END OF SECTION 02915

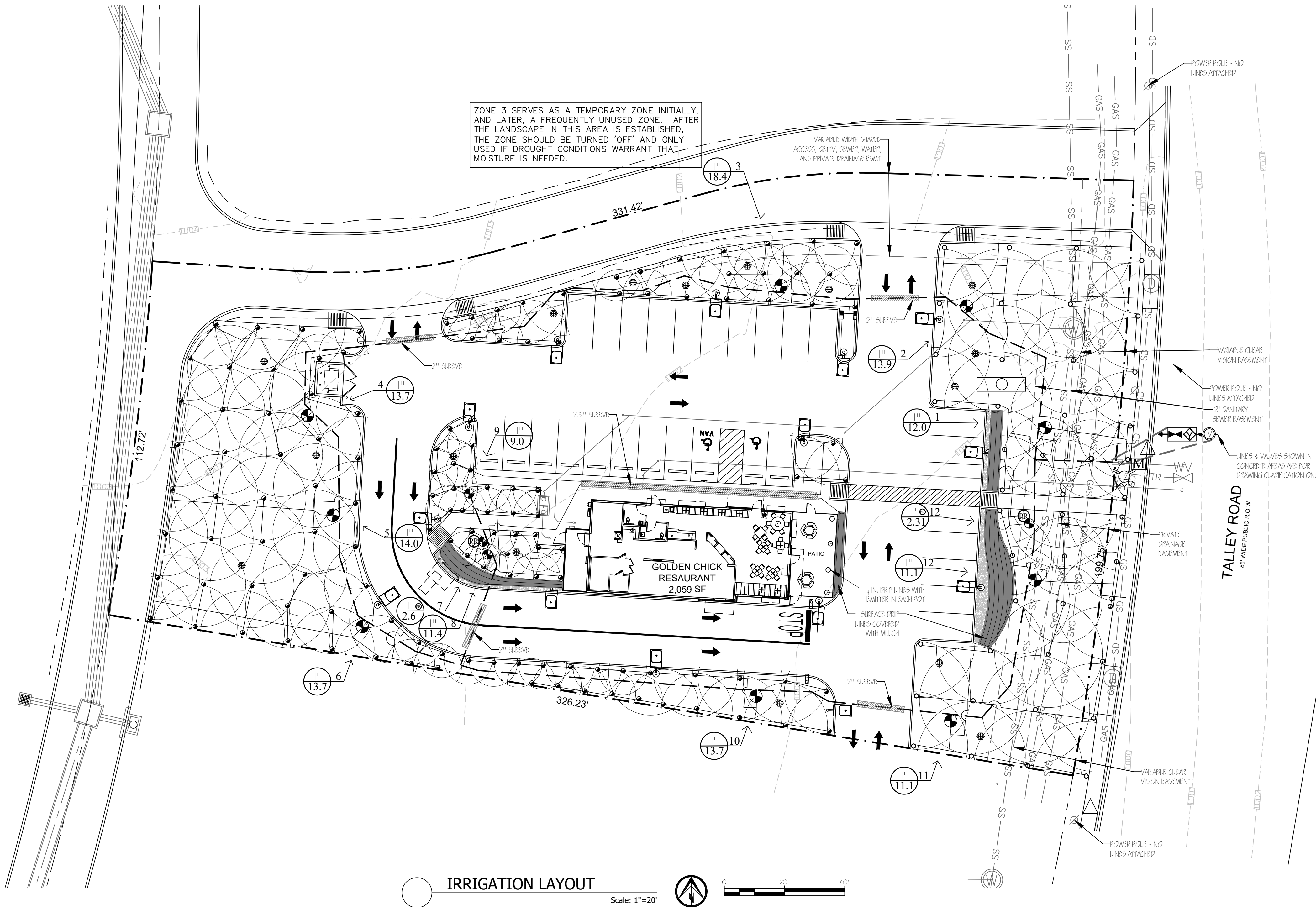

ZONE 3 SERVES AS A TEMPORARY ZONE INITIALLY, AND LATER, A FREQUENTLY UNUSED ZONE. AFTER THE LANDSCAPE IN THIS AREA IS ESTABLISHED, THE ZONE SHOULD BE TURNED "OFF" AND ONLY USED IF DROUGHT CONDITIONS WARRANT THAT MOISTURE IS NEEDED.

- LEGEND**
- ⊕ LOCATION OF PROPOSED TREES
  - RAINBIRD 1806-SAM HEAD
  - 14' R-VAN NOZZLE, P45, .32 Q, .63 H, 1.27 F GPM
  - 18' R-VAN NOZZLE, P45, .5 Q, 1.01 H, 1.85 F GPM
  - 5X15' STRIP R-VAN NOZZLE, LCS, RCS, .24 H GPM
  - 5X30' STRIP R-VAN NOZZLE, SST, .48 F GPM
  - ▨ NETAFIM TECHLINE CV DRIPPERLINE #TLV4-18, 18" SPACING FOR ABOVE GROUND DRIP, #TLV4-12, 12" SPACING FOR SUB-TERRAIN
  - ⊕ FLUSHING VALVE NETAFIM TL50V
  - ▨ CLASS 200 PVC SLEEVE PIPES, AS MARKED
  - ▨ CLASS 200 PVC MAINLINE PIPE, 1-1/4"
  - ▨ CLASS 200 PVC LATERAL PIPE, 1" UNLESS MARKED
  - ▨ PROPERTY LINE
  - ⊕ FEBCO DOUBLE CHECK VALVE ASSEMBLY - 850 1" D.C.A. INSTALLED PER CITY CODE
  - ⊕ INLINE WYE STRAINER
  - ⊕ ISOLATION VALVE, 1" SLIP BALL VALVE
  - ⊕ PRESSURE REGULATOR, NETAFIM
  - ⊕ 1" WATER METER
  - ⊕ WEATHERMATIC AUTOMATIC CONTROLLER WITH MINI-WEATHER STATION (RAIN & FREEZE SENSOR)
  - ⊕ RAINBIRD PEB SERIES ELECTRIC VALVE WITH FLOW CONTROL
  - ⊕ CONTROL VALVE
  - ⊕ ZONE NUMBER
  - ⊕ VALVE SIZE
  - ⊕ FLOW IN GAL. PER MINUTE (GPM)

47.2 PSI DESIGN PRESSURE THIS DESIGN  
 DESIGN BASED ON 55 PSI STATIC PRESSURE AT METER  
 CONTRACTOR TO VERIFY BEFORE PROCEEDING - A PRESSURE  
 REDUCTION VALVE TO BE INSTALLED ON THE DOWN-SIDE OF THE  
 BACK FLOW DEVICE IF SOURCE WATER PRESSURE EXCEEDS 65 PSI

**Jurisdiction of Project**

REGULATORY AUTHORITIES:  
 CITY OF SAN ANTONIO PLANNING & ZONING  
 1400 S FLORES STREET  
 SAN ANTONIO, TEXAS 78208  
 210.207.0145  
 TEXAS COMMISSION ON ENVIRONMENTAL QUALITY (TCEQ)  
 P.O. BOX 13087, AUSTIN, TEXAS 78711-3087  
 WWW.TCEQ.STATE.TX.US

**Site Location**

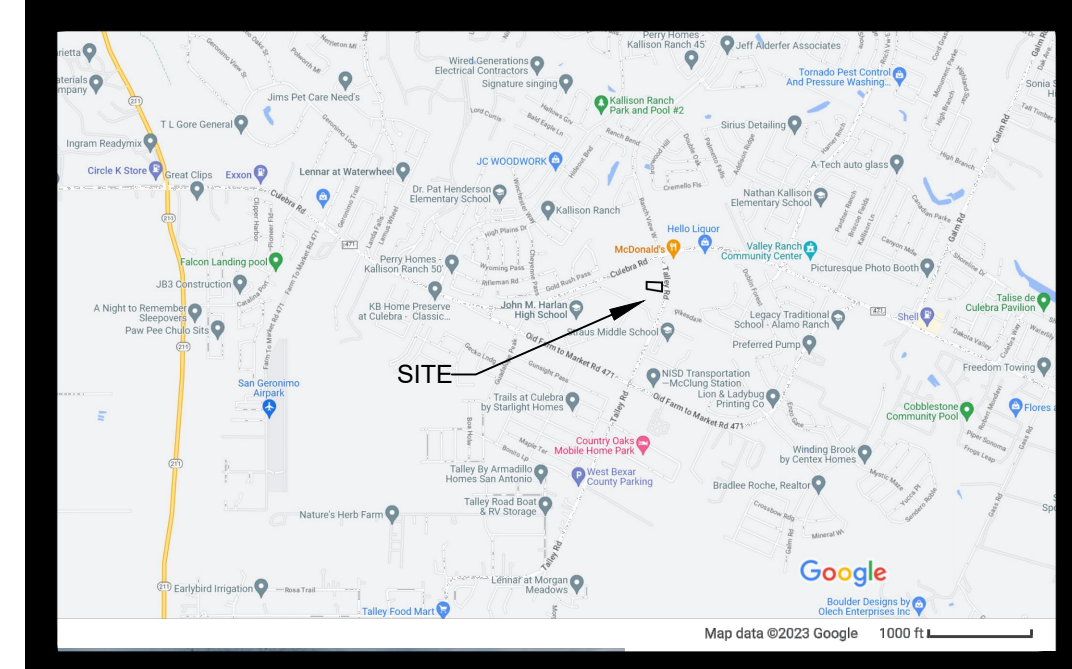

**Owner & Professionals Information**

**OWNER**  
 GOLDEN CHICK OPERATION CORPORATION  
 1131 ROCKINGHAM DR. SUITE 250, RICHARDSON, TX 75080  
 ATTN: BRIAN GILBERT, 972-831-0911

**ARCHITECT**  
 MLA - MICHAEL LEGG ARCHITECT  
 26116 HIGH TIMBER PASS  
 SAN ANTONIO, TEXAS 78260  
 ATTN: MICHAEL LEGG, 210-416-4935

**LANDSCAPE ARCHITECT**  
 FELDMAN DESIGN STUDIOS  
 P.O. BOX 832346, RICHARDSON, TEXAS 75083  
 ATTN: CAROL FELDMAN, 972-523-4944  
 CAROL@FELDMANDESIGN.COM

NO.	ITEM DESCRIPTION	DATE:
1.	SUBMITAL DOCUMENTS	6/7/23
2.	IRRIGATION ADDED TO SET	7/21/23
3.		
4.		
5.		
6.		
7.		



These drawings have been prepared by or under the supervision of Carol Feldman, Registered Landscape Architect #2080, Licensed Irrigator LI #20245

**GOLDEN CHICK RESTAURANT**  
 TALLEY RD AT CULEBRA  
 SAN ANTONIO, TEXAS



SHEET NO.  
**L2.01**

SECTION 02810 --- IRRIGATION  
NOTES

1. IRRIGATION SYSTEM MUST BE INSTALLED BY LICENSED IRRIGATOR.
2. IRRIGATION CONTRACTOR WILL SECURE ALL REQUIRED PERMITS AND PAY ALL ASSOCIATED FEES UNLESS OTHERWISE NOTED.
3. COORDINATE IRRIGATION INSTALLATION WITH PLANTING PLAN AND SITE CONDITIONS TO PROVIDE COMPLETE COVERAGE. THE IRRIGATION CONTRACTOR SHALL MAKE MINOR ADJUSTMENTS TO ENSURE PROPER COVERAGE AT NO ADDITIONAL COST TO OWNER.
4. VALVE BOXES SHALL BE INSTALLED FLUSH WITH GRADE, SUPPORTED BY BRICKS IF NEEDED, WITH 3 INCHES OF CLEAN PEA GRAVEL LOCATED BELOW THE VALVE.
5. DRIP IRRIGATION SYSTEM IN BEDS TO BE INSTALLED AT GRADE WITH 2" MULCH FULLY COVERING ALL LINES.
6. DRIP IRRIGATION SYSTEM IN TURF AREAS IS TO BE INSTALLED SUBSURFACE. FILL TURF AREAS TO A GRADE DEPTH OF MINUS 6" AND LAY LINES. COVER WITH PLANTING SOIL & SOD SO THAT DRIP REMAINS BURIED 6" BELOW GRADE.
7. L.I.C. SHALL SELECT MPR SERIES SPRAY NOZZLES FOR 'HEAD-TO-HEAD' COVERAGE, ADJUSTED FOR MINIMUM OVERSPRAY ONTO WALLS, FENCES AND WALKS. NO OVERSPRAY INTO STREET IS PERMITTED.
8. IRRIGATOR MUST ABIDE BY THE CITY IRRIGATION CODES, INCLUDING, BUT NOT LIMITED TO THE FOLLOWING:
  - 8.1. RAIN AND FREEZE SENSOR INSTALLED
  - 8.2. PURPLE PRIMER MUST BE USED ON ALL PVC JOINTS.
  - 8.3. IRRIGATION SYSTEM MUST MEET STATE INSTALLATION CODES (TCEQ).
  - 8.4. IRRIGATOR MUST REQUEST AN INSPECTION FROM THE CITY WHEN COMPLETE, AND MUST PROVIDE: COPY OF MAINTENANCE CHECKLIST REQUIRED BY TCEQ CODES AND COPY OF TEST RESULTS OF THE BACKFLOW PREVENTION ASSEMBLY.
  - 8.5. PLANS MUST BE ON SITE DURING INSTALLATION AND INSPECTION.
  - 8.6. DRIP LINES AND HEADS TO BE LOCATED FOUR (4") INCHES FROM FOUNDATION, PARKING LOTS, DRIVEWAY, ETC.
  - 8.7. AN 'AS-BUILT' DRAWING AND RUN SCHEDULE MUST BE PRODUCED AND A COPY GIVEN TO THE LANDOWNER.
  - 8.8. A PERMANENT STICKER WITH IRRIGATOR'S NAME, LICENSE NUMBER, COMPANY NAME, TELEPHONE NUMBER AND THE DATE OF WARRANTY PERIOD SHALL BE AFFIXED TO EACH AUTOMATIC CONTROLLER INSTALLED BY THE IRRIGATOR.
9. CONTRACTOR TO PROVIDE THE FOLLOWING FOR CITY INSPECTION:
  - 9.1. ALL REQUIRED VALVE BOXES SHALL BE INSTALLED, THE LID OF THE VALVE BOX SHALL BE LEFT OPEN UNTIL APPROVED BY THE CODE OFFICIAL.
  - 9.2. PIPING AN VALVES INCLUDING ISOLATION VALVES, WYE STRAINERS, BACKFLOW PREVENTERS, AND MASTER VALVES SHALL BE LEFT UNCOVERED FROM THE POINT OF CONNECTION TO A POINT OF THREE (3) FEET DOWN STREAM OF THE MASTER VALVE AND PRESSURIZED.
  - 9.3. ALL WIRING SPLICES SHALL BE LEFT UNCOVERED OR IF THERE ARE NO SPLICES WIRING MAY BE COVERED TO A POINT WITHIN TWO (2) FEET OF ANY VALVES.
  - 9.4. ALL ZONE VALVES AND MASTER VALVES SHALL NOT BE CONCEALED FOR A SPACE OF TWO (2) FEET AND UP AND DOWN STREAM OF THE VALVE. INCLUDING THE PIPING CONNECTIONS TO THE VALVE.
  - 9.5. THE LAST EMISSION DEVICE WITH THE GREATEST DEVELOPED LENGTH FROM THE POTABLE WATER SOURCE SHALL BE LEFT EXPOSED FOR A DISTANCE OF TWO (2) FEET FOR INSPECTION AND TESTING.

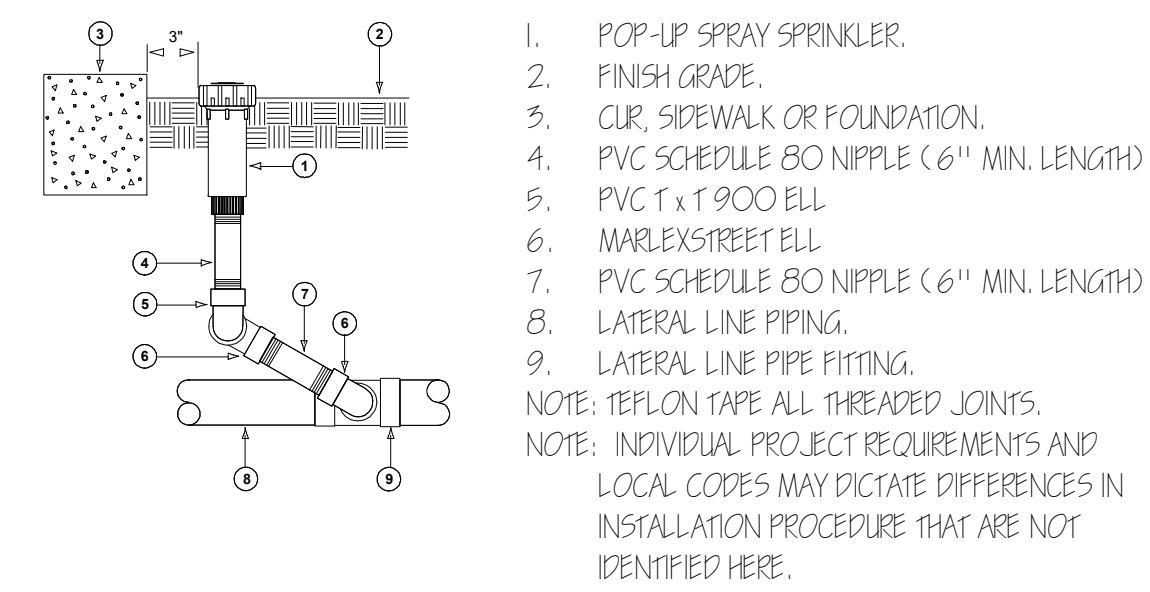
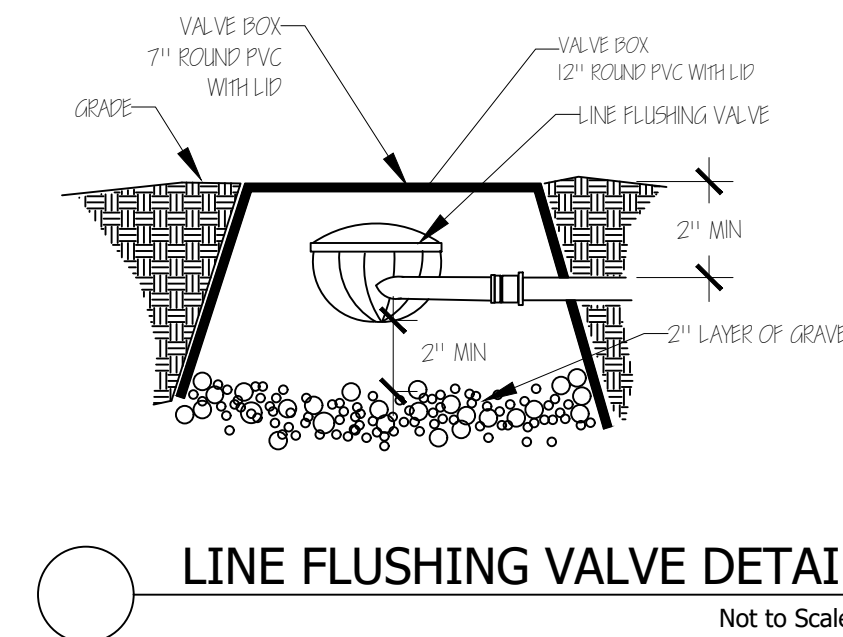
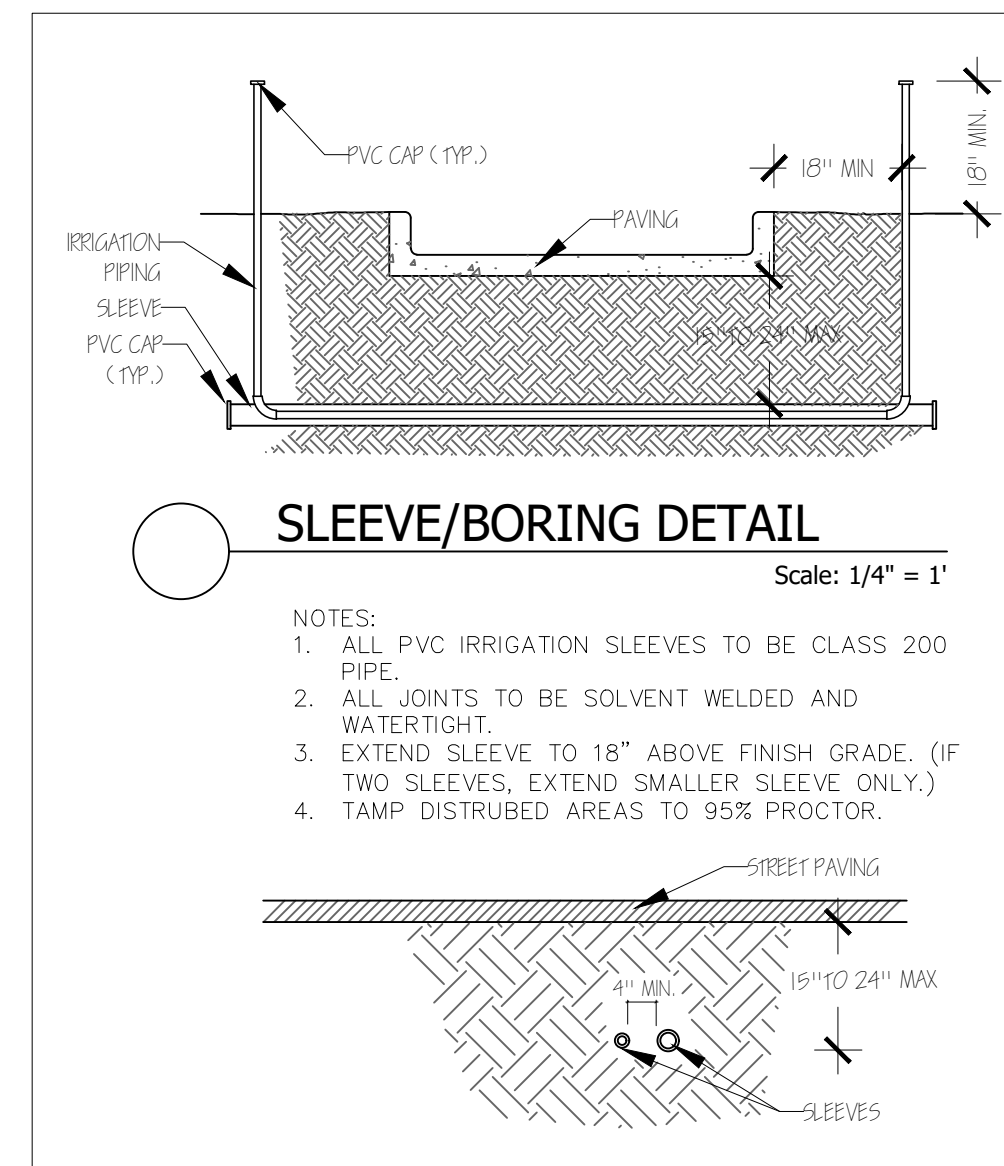
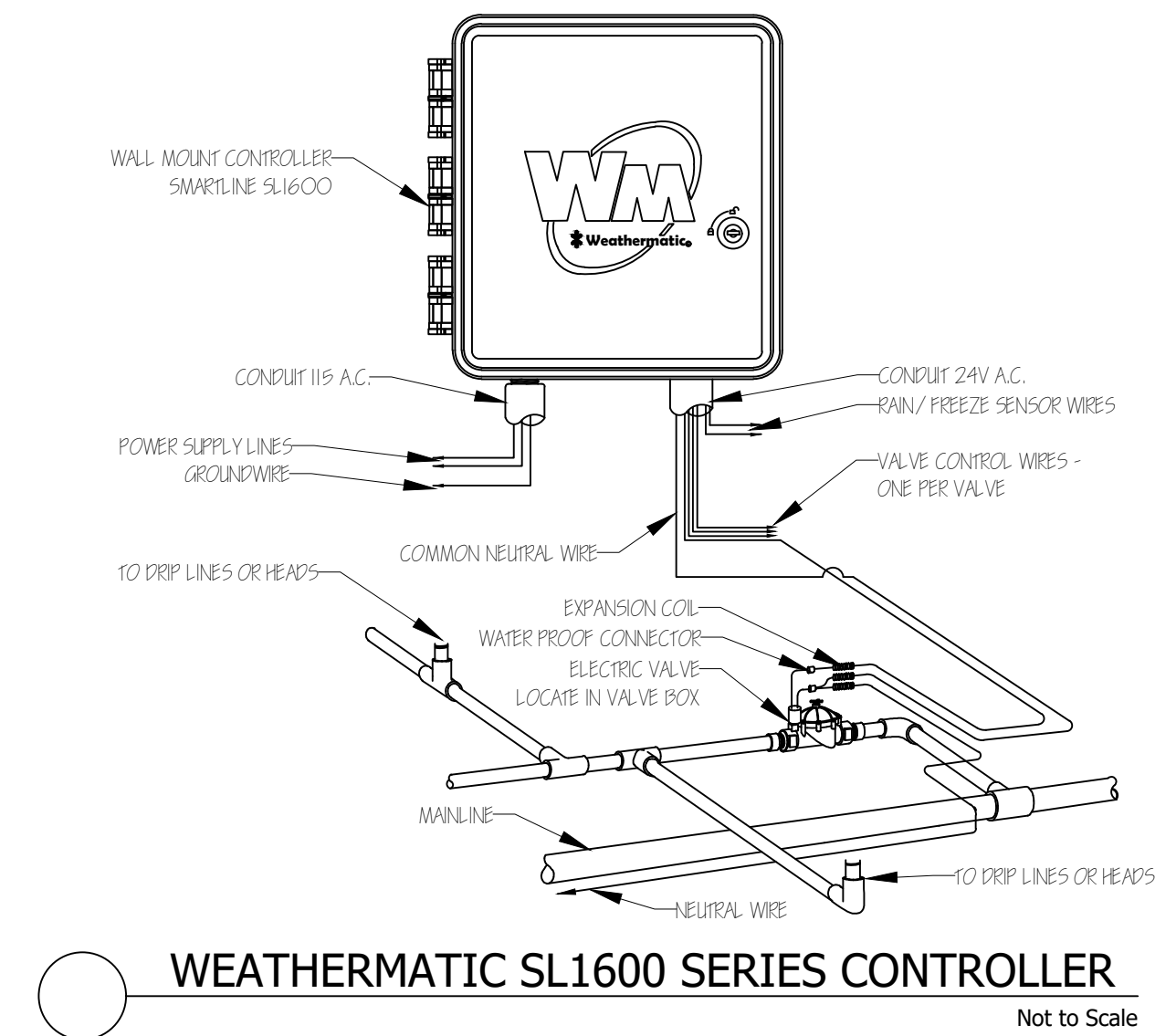
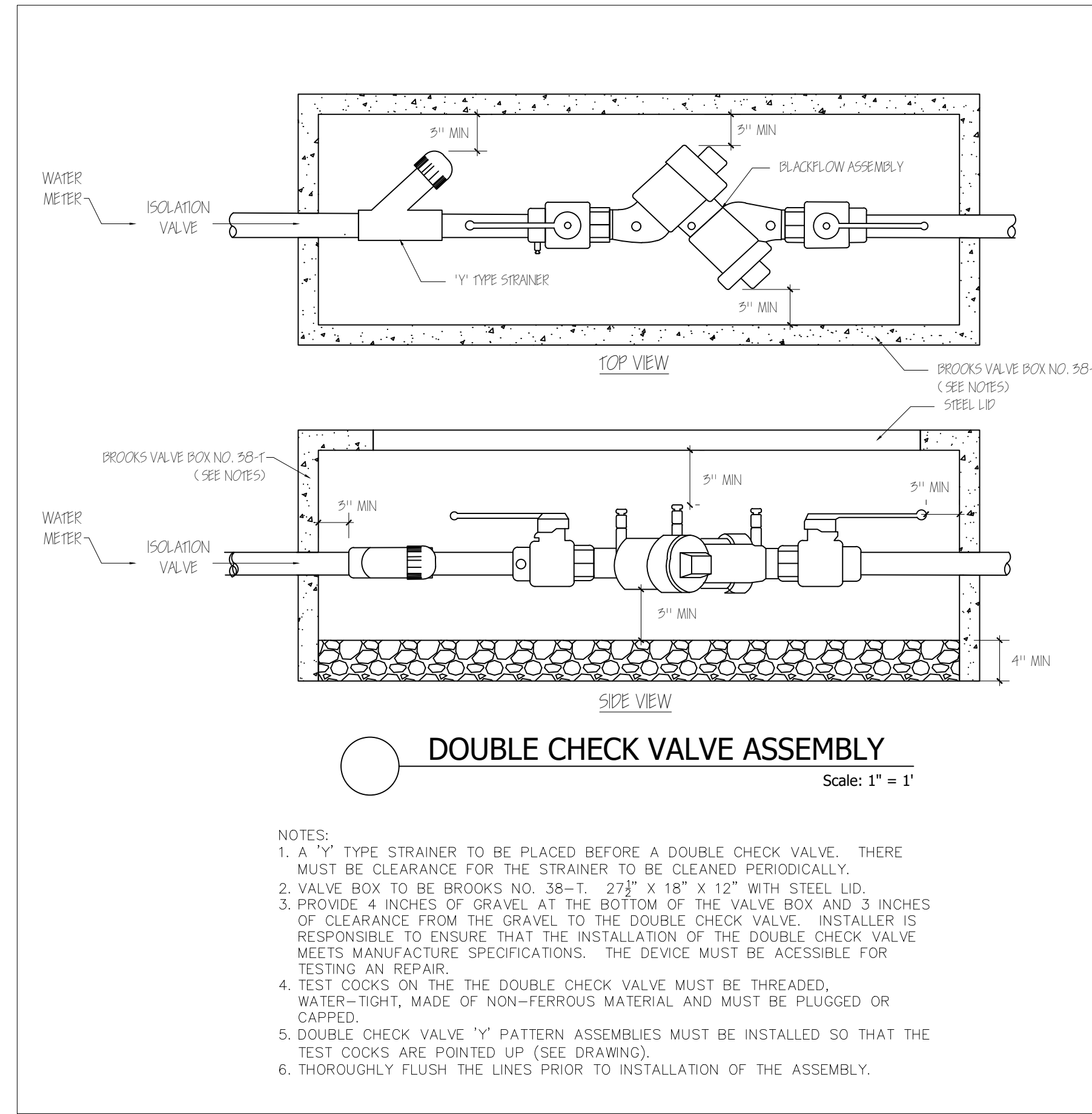

NO.	ITEM DESCRIPTION	DATE:
1.	SUBMITTAL DOCUMENTS	6/7/23
2.	IRRIGATION ADDED TO SET	7/21/23
3.		
4.		
5.		
6.		
7.		



These drawings have been prepared by or under the supervision of Carol Feldman, Registered Landscape Architect #2080, Licensed Irrigator #20245

**GOLDEN CHICK RESTAURANT**  
TALLEY RD AT CULEBRA  
SAN ANTONIO, TEXAS



SHEET NO.

**L2.02**