

LOT 3, BLOCK 2
CROSSROADS ADDITION
T. NO. D217048919,
O.P.R.T.C.T.

JTO ENTERPRISES, LLC
NO. D217230159,
O.P.R.T.C.T.
PD 827
FOOD COMMERCIAL (E)

SHERWIN WILLIAMS
4,455 SF
LOT 4,
BLOCK 2
0.932 ACRES

HUNTER CROSSROADS, LP
INST. NO. D207294400,
O.P.R.T.C.T.
PD 829
GENERAL COMMERCIAL (F)

HUNTER CROSSROADS, LP
INST. NO. D207294400,
O.P.R.T.C.T.
PD 830
LIGHT INDUSTRIAL (I)

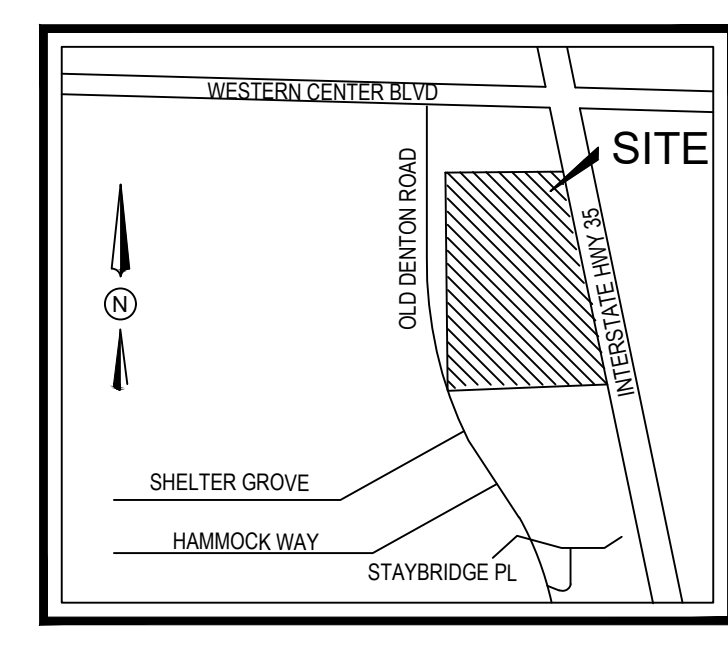

VICINITY MAP
N.T.S.

LANDSCAPE ARCHITECT
1782 W McDERMOTT DR.
ALLEN, TEXAS 75013
(469) 369-4448
CHRIS@STUDIOGREENSPOT.COM



10.26.2023

URBAN FORESTRY CALCULATIONS

New Tree Planting (phase 2)			
O	Required new planting coverage	(F - M - dd)	10,276 S.F. 0.20
P	6 large canopy trees @ 2000 sq ft per tree	(Qty x 2000)	12,000 S.F. 0.23
Q	0 medium canopy trees @ 700 sq ft per tree	(Qty x 700)	0 S.F.
R	3 small canopy trees @ 100 sq ft per tree	(Qty x 100)	300 S.F.
S	Total Planting	(P+Q+R)	12,300 S.F. 0.23
Parking Areas: 1 or 2 family residential are exempt (phase 2)			
T	Area of parking	→	12,966 S.F. 0.24
U	Required canopy coverage of parking areas (40%)	(T x .40)	5,187 S.F. 0.10
V	Area of canopy coverage being provided for parking	→	6,100 S.F. 0.14
W	Excess/deficient parking canopy	(V-U)	913 S.F. 0.04
Fulfillment of Requirements (phase 2)			
X	Total required canopy coverage for site	(F)	10,276 S.F. 0.20
Y	Provided canopy coverage	(M+S+dd)	12,300 S.F. 0.23
Z	Excess/deficient overall canopy	(Y-X)	2,024 S.F. 0.03

PLANT MATERIAL SCHEDULE

TREES	TYPE	QTY	COMMON NAME	BOTANICAL NAME	SIZE	REMARKS
CE	3	Cedar Elm	<i>Ulmus crassifolia</i>	3" cal.	B&B, 12 ht., 6' spread, 5' clear trunk	
LO	3	Live Oak	<i>Quercus virginiana</i>	3" cal.	container, 12' ht., 6' spread, 5' clear trunk	
CM	3	Crepe Myrtle	<i>Lagerstroemia indica</i>	2" cal.	container, 8' ht., tree form	

NOTE: Plant list is an aid to bidders only. Contractor shall verify all quantities on plan. All heights and spreads are minimums. All plant material shall meet or exceed remarks as indicated. All trees to have straight trunks and be matching within varieties.

UFC23-0236
Approved UF-2

APPROVED
By Lucretia Summers at 9:47 am, Nov 07, 2023

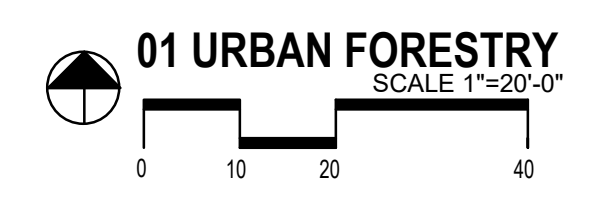

SHERWIN WILLIAMS

2101 AVONDALE HASLET RD.
VISTA CROSSROADS ADDITION BLOCK 2, LOT 4
FORT WORTH, TEXAS

PROJECT CONTACT LIST	
<p>ENGINEER TRIANGLE ENGINEERING LLC 1782 W McDERMOTT DRIVE ALLEN, TEXAS 75013 CONTACT: JACK ZANGER TEL: 469-331-8566</p>	<p>OWNER/DEVELOPER FORT WORTH DEVELOPMENT GROUP, LLC 120 MARKET SQ., FLOOR 2, PINEHURST, NC 28374 CONTACT: GAVIN MELIA TEL: 910 724 6720</p>
<p>SURVEYOR TRAVERSE LAND SURVEYING LLC 14200 MIDWAY ROAD, SUITE 130 DALLAS, TX 75224 CONTACT: GRAYSON CEBALLOS TEL: 469-426-7339</p>	

SHERWIN WILLIAMS
2101 AVONDALE HASLET RD.
FORT WORTH, TEXAS

ISSUE:
FOR APPROVAL 10.26.2023

DATE:
10.26.2023

SHEET NAME:
URBAN FORESTRY- PHASE 2

SHEET NUMBER:

UF-2